

Polished Steel Pull Handle M4 x 114

PSPHM4114

This u-shaped handle is a popular choice for furniture in commercial and domestic settings. The shape is well suited to cabinets, doors, drawers and enclosures and its stainless steel construction offers significantly improved corrosion resistance in wet rooms, medical environments and outdoors.



Technical Specifications

B	Height (mm)	30
A	Length (mm)	114
	Product Type	simple
	Thread Size (D1)	M4
D	Thread Length (L) (mm)	22
E	Handle Width (mm)	8
C	Distance Between Fixing Centres (mm)	106

Dimensions

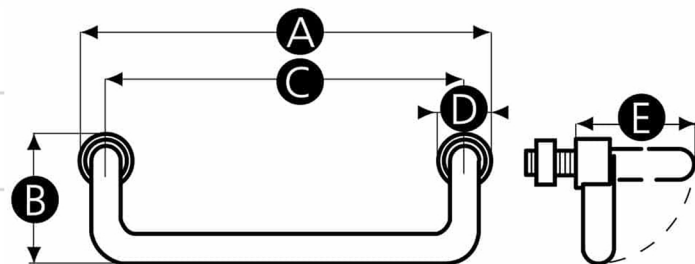

©Copyright
Rencol