

Super Heavy Jacking Castor 250mm Wheel 2500KG Load Capacity JU2500-V95250X80-ROSS

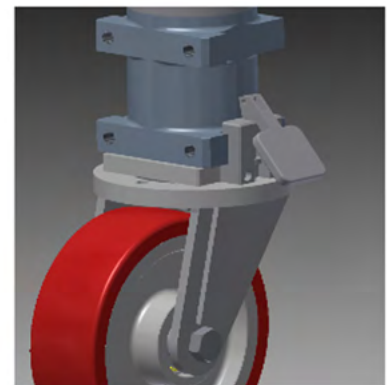

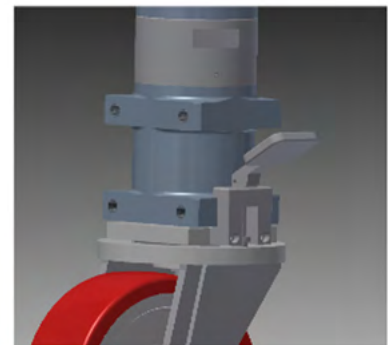

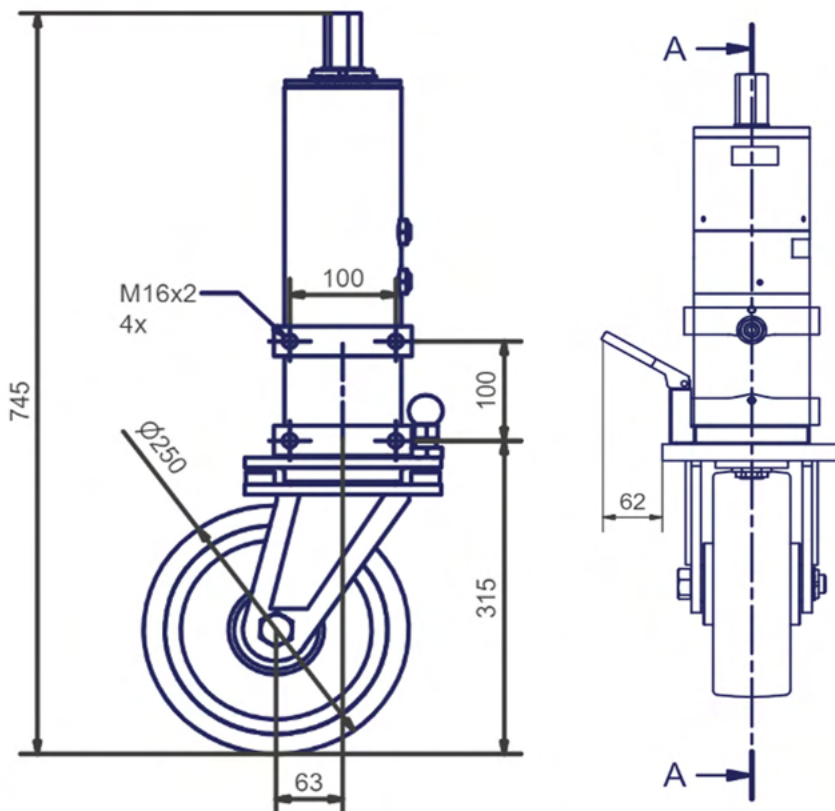





















It has a robust machined steel body and a heavy duty 250mm polyurethane wheel with cast iron centre. It has a lift of 150mm to provide a quick accurate solution where height adjustment is required. The castor is fitted with a 4-way directional lock as standard for added easy of movement. The jacking operation is achieved by a hexagonal spanner at the top of the jacking unit. All steel parts of the castor are machined from billets.



Dimensions



Technical Specifications

 Castor Type	Jacking Castors
 Bearing Type	Taper Roller
 Colour	Orange
 Height (mm)	745
 Load Capacity (kg)	2500
 Manufacturer Part No.	HJC2500
 Product Type	Jacking Castors
 Tread Width (mm)	80
 Temperature Range	-30 to +45 degrees centigrade
 Load Capacity Dynamic (kg)	2000
 Load Capacity Static (kg)	2500
 Max Load Capacity for 2 Jacking Castors	5000
 Max Load Capacity of 4 Castors	7500
 Total Height to Plate Lower Bolt Hole	315
 Jacking Unit Height From Plate Lower Bolt Hole	430
 Jacking Unit Height When Extended (76mm)	825
 Plate Hole Centres Length (mm)	100
 Plate Hole Centres Width (mm)	100
 Plate Hole Diameter	M16
 Operating Method	Hexagonal wrench
 Swivel Radius	197
 Total Castor Height	745
 Wheel Colour	Yellow
 Wheel Material	Polyurethane
 Wheel Centre	Cast Iron
 Wheel Diameter(mm)	250