

TECHNICAL DRAWING FOR PROSOLVE GLAZING INSERT (TZ2SGE)

This is a 2-part system to allow glazed panels to be added to the ProSolve ProFrame system.

PART 1 – NR2907A

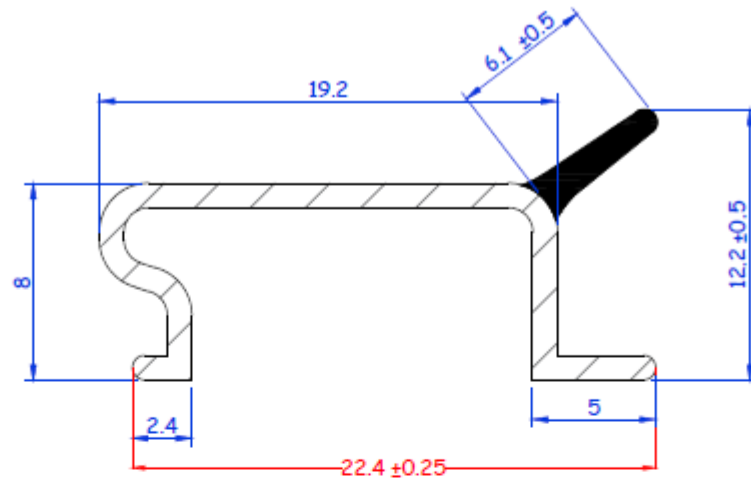

MUST be measured when clipped into Gauge 1524.

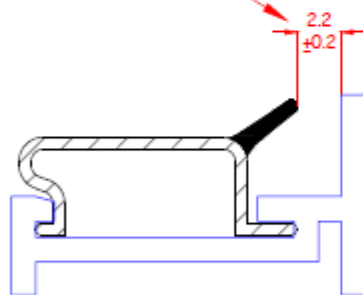

HT.2053/B - (NR2906)

Note:
Clips into HT.2053/B (NR2906) interference fit.

Tight tolerance on bottom rear leg.

Nominal wall thickness 1mm unless specified otherwise

RED Dimension denotes Critical Dimension.

 Denotes Rigid PVC

 Denotes Flexible PVC

ACTUAL SIZE



PART 2 – NR2906

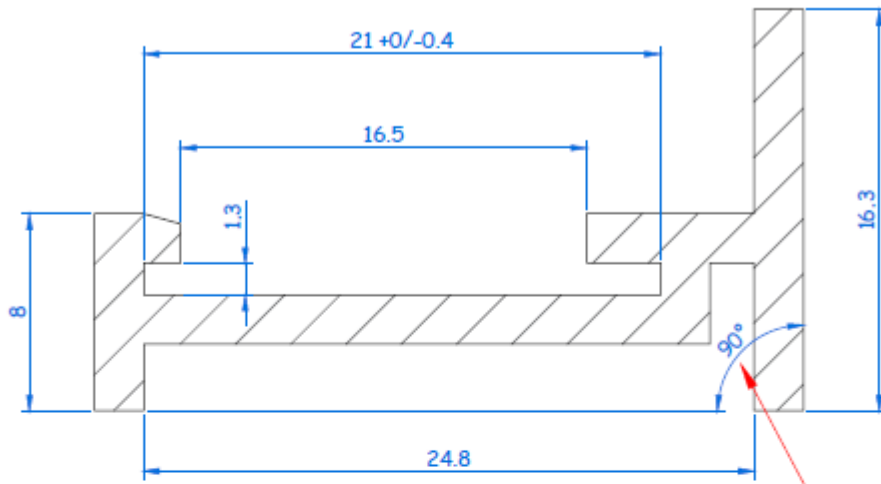

Use square to make sure vertical leg is at 90° to the base.

Note:

HT.2055/B (2907ND) fits into gap.
Interference fit

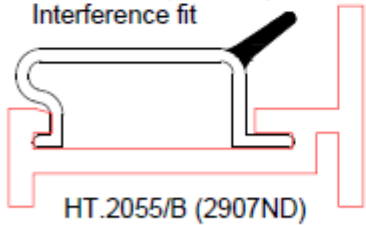

Nominal wall thickness 2mm
unless specified otherwise

 Denotes Rigid PVC

ACTUAL SIZE

